



## Proposed Extension to Double Yellow Lines Brenley Lane, Brenley, Nr Faversham

Following requests from the Police, it is proposed to extend the existing double yellow lines on the west side of Brenley Lane. Vehicles are currently parking on both sides of Brenley Lane, creating problems for vehicle access and also preventing pedestrians from using the footway. It is therefore proposed to extend the existing double yellow lines on the west side of the road, from the Brenley Corner Roundabout down to the T junction, as shown on the supplied plan.

The installation of these parking amendments will be dependant on available funding.

If you support or object to the proposal please complete the reply slip below and return to the Borough Council in the pre-paid envelope provided, before Friday 5<sup>th</sup> November 2010. A space has also been provided to allow you to add any further comments you may have.

---

### Proposed Extension to Double Yellow Lines – Brenley Lane, Brenley, Nr Faversham

Please tick one of the following boxes

I Support the proposal to extend the double yellow lines

I Object to the proposal

Name & Address	Comments

The information supplied will only be used in conjunction with this proposal, and used for geographical analysis purposes only



Plan of proposed restrictions

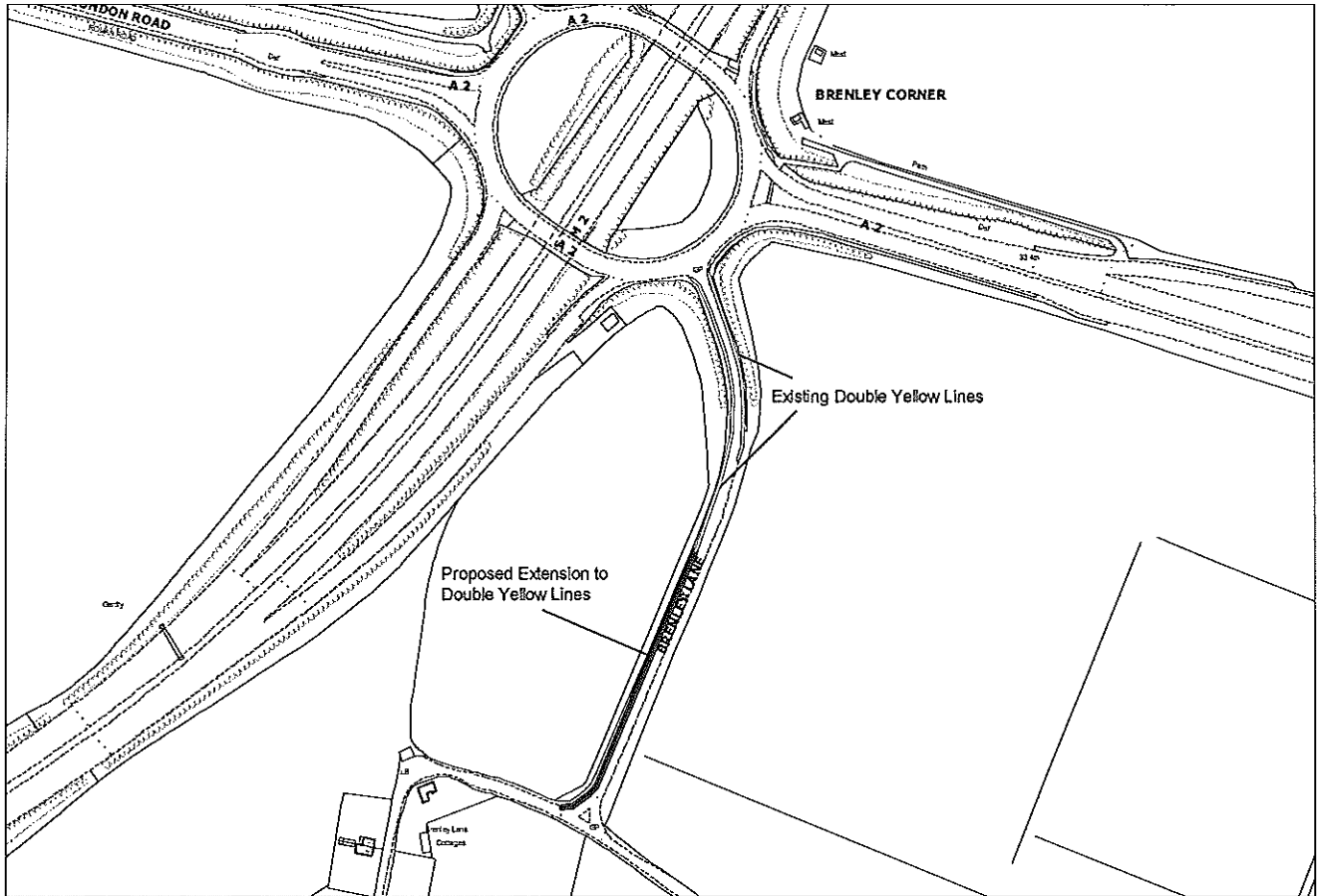

ADDRESS BLOCK



## Proposed Double Yellow Lines Belmont Road/Queenborough Road, Halfway

A request has been received from the Police for double yellow lines to be installed on the junction of Belmont Road and Queenborough Road in Halfway, on the Isle of Sheppey. It has been reported that vehicles are currently parking close to the junction, creating a safety hazard by obstructing the sightlines of those vehicles using the junction.

It is therefore proposed to install double yellow lines on this junction as shown on the plan overleaf.

The installation of these parking amendments will be dependant on available funding.

If you support or object to the proposal please complete the reply slip below and return to the Borough Council in the pre-paid envelope provided, before Friday 5<sup>th</sup> November 2010. A space has also been provided to allow you to add any further comments you may have.

---

### Proposed Installation of Double Yellow Lines – Belmont Road/Queenborough Road, Halfway

Please tick one of the following boxes

I Support the proposal to install double yellow lines
  I Object to the proposal

Name & Address	Comments

The information supplied will only be used in conjunction with this proposal, and used for geographical analysis purposes only



Plan of proposed restrictions

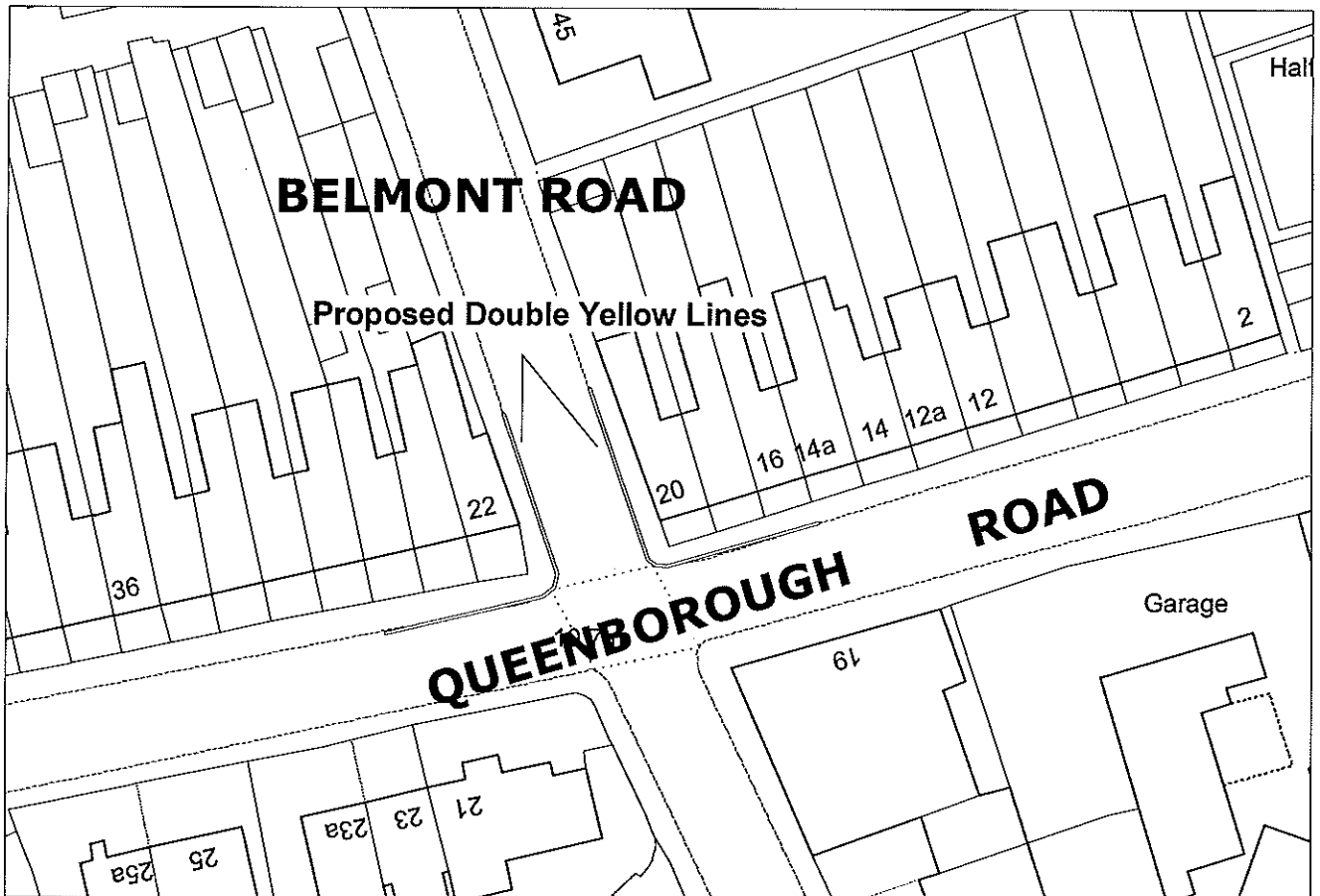

ADDRESS BLOCK



## Proposed Single Yellow Line Lay-by, London Road, Norton

Following receipt of a petition, Kent County Council made a request to the Borough Council for parking restrictions to be considered in the lay-by on the south side of the A2 London Road, in Norton, near Sittingbourne.

These restrictions are to tackle problems with HGVs parking in the lay-by, causing obstructions to sightlines for vehicles exiting the nearby property's driveway, and the proposals consist of parking restrictions at any time for vehicles over a weight of 5 tonnes.

The installation of any parking restrictions will be dependant on available funding.

If you support or object to the proposal please complete the reply slip below and return to the Borough Council in the pre-paid envelope provided, before Monday 22<sup>nd</sup> November 2010. A space has also been provided to allow you to add any further comments you may have.

---

### Proposed Single Yellow Line – Lay-by, London Road, Norton

Please tick one of the following boxes

I Support the proposal to install a single yellow line
  I Object to the proposal

Name & Address	Comments

The information supplied will only be used in conjunction with this proposal, and used for geographical analysis purposes only



Plan of proposed restrictions

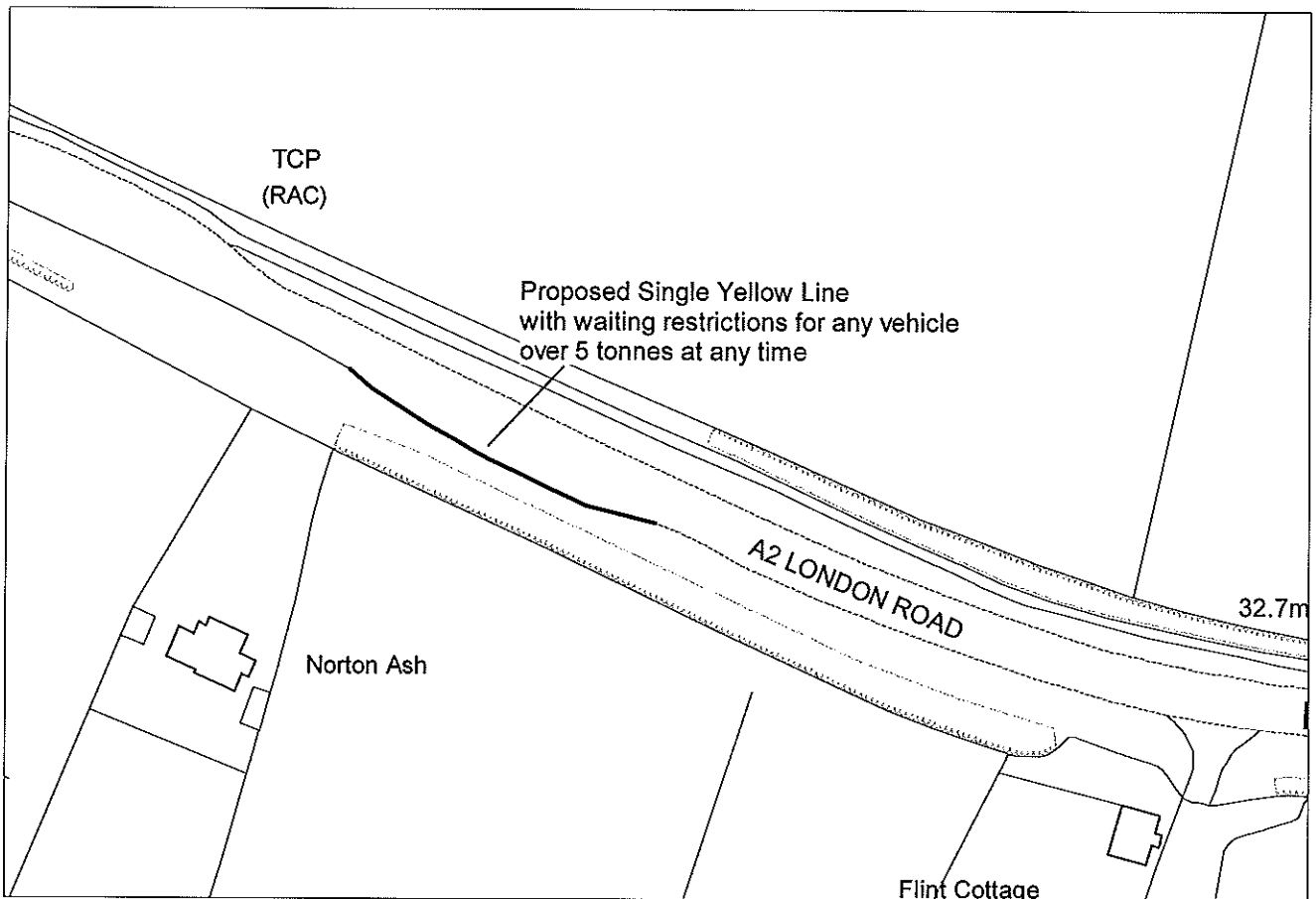

---

ADDRESS BLOCK

# ANNEX A

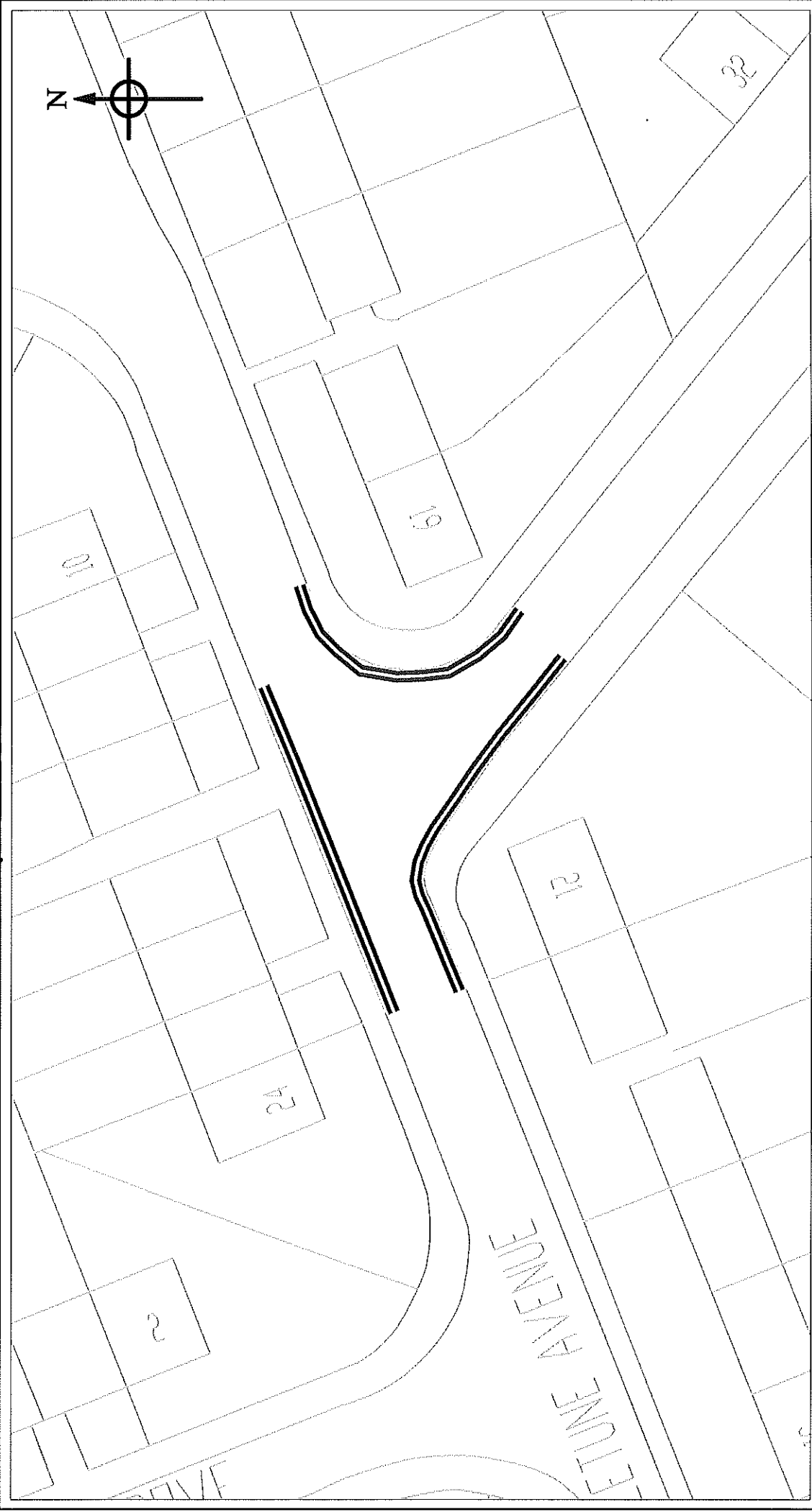

Key



Proposed Double Yellow Lines

Middlelune Avenue Junction Newbridge Avenue, Sittingbourne - Proposed Waiting Restrictions

DRAWN	BOC
DATE	Oct 10
SCALE	NTS
ES/2738/107	

Majesty's Stationery Office (C) Crown copyright. Unauthorised reproduction infringes Crown copyright and may lead to prosecution or civil proceedings.  
Swale Borough Council, LA079626, 2001



# ANNEX A

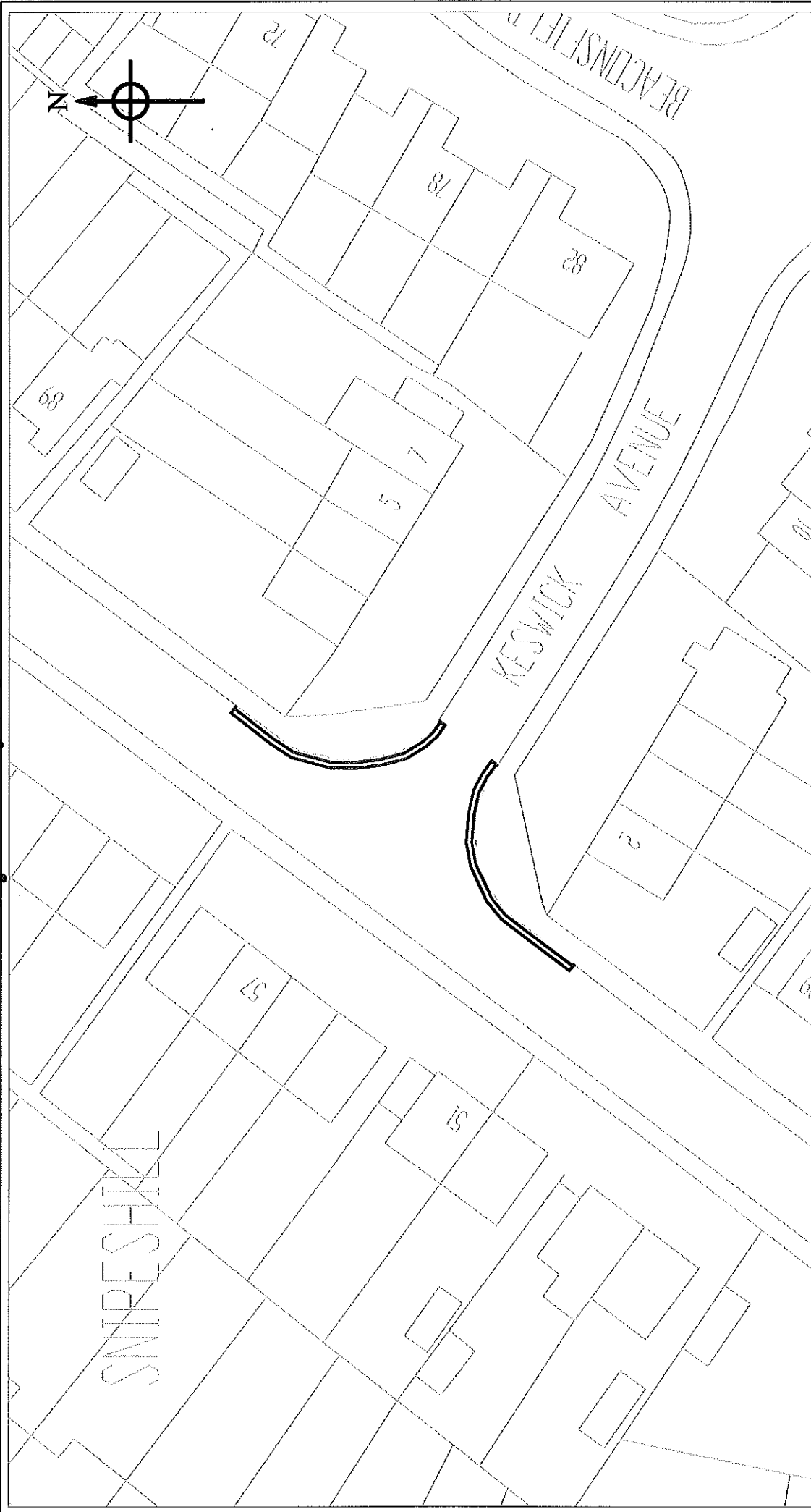

**Key**

 Proposed Double Yellow Lines

Keswick Avenue Junction Woodberry Drive  
Sittingbourne - Proposed Waiting Restrictions

DRAWN	BOC
DATE	Oct 10
SCALE	NTS
ES/2738/106	

Her Majesty's Stationery Office. Crown Copyright. Unauthorised reproduction or use of any part of this copyright material may lead to prosecution or civil proceedings.  
Swale Borough Council, LA079626, 2001





# ANNEX A



Her Majesty's Stationery Office (HMSO) Crown Copyright. Unauthorised reproduction infringes Crown Copyright and may lead to prosecution or civil proceedings.  
Swale Borough Council, LA079626, 2001



<b>Key</b>	<p>===== Proposed Double Yellow Lines</p> <p>Castle Road (Eurolink Estate), Sittingbourne - Proposed Waiting Restrictions</p>	DRAWN	BOC
		DATE	Oct 10
		SCALE	NTS
			ES/2738/108



## Proposed Extension to Parking Bays High Street, Milton Regis

Following requests from businesses through a local Councillor, the Borough Council are proposing to extend the existing parking bays on the west side of Milton High Street, by approximately 16 metres in a southerly direction, towards Crown Road. This will increase the available short term parking for visitors to shops in the High Street.

The possibility of extending the parking bays in the other direction, towards the zebra crossing, was also explored but as the existing bus stop markings are already at the minimum required size this was not an option.

The installation of these parking amendments will be dependant on available funding.

If you support or object to the proposal please complete the reply slip below and return to the Borough Council in the pre-paid envelope provided, before Friday 5<sup>th</sup> November 2010. A space has also been provided to allow you to add any further comments you may have.

---

### Proposed Extension to Parking Bays – High Street, Milton Regis

Please tick one of the following boxes

I Support the proposal to extend the parking bays

I Object to the proposal

Name & Address	Comments

The information supplied will only be used in conjunction with this proposal, and used for geographical analysis purposes only



Plan of proposed restrictions

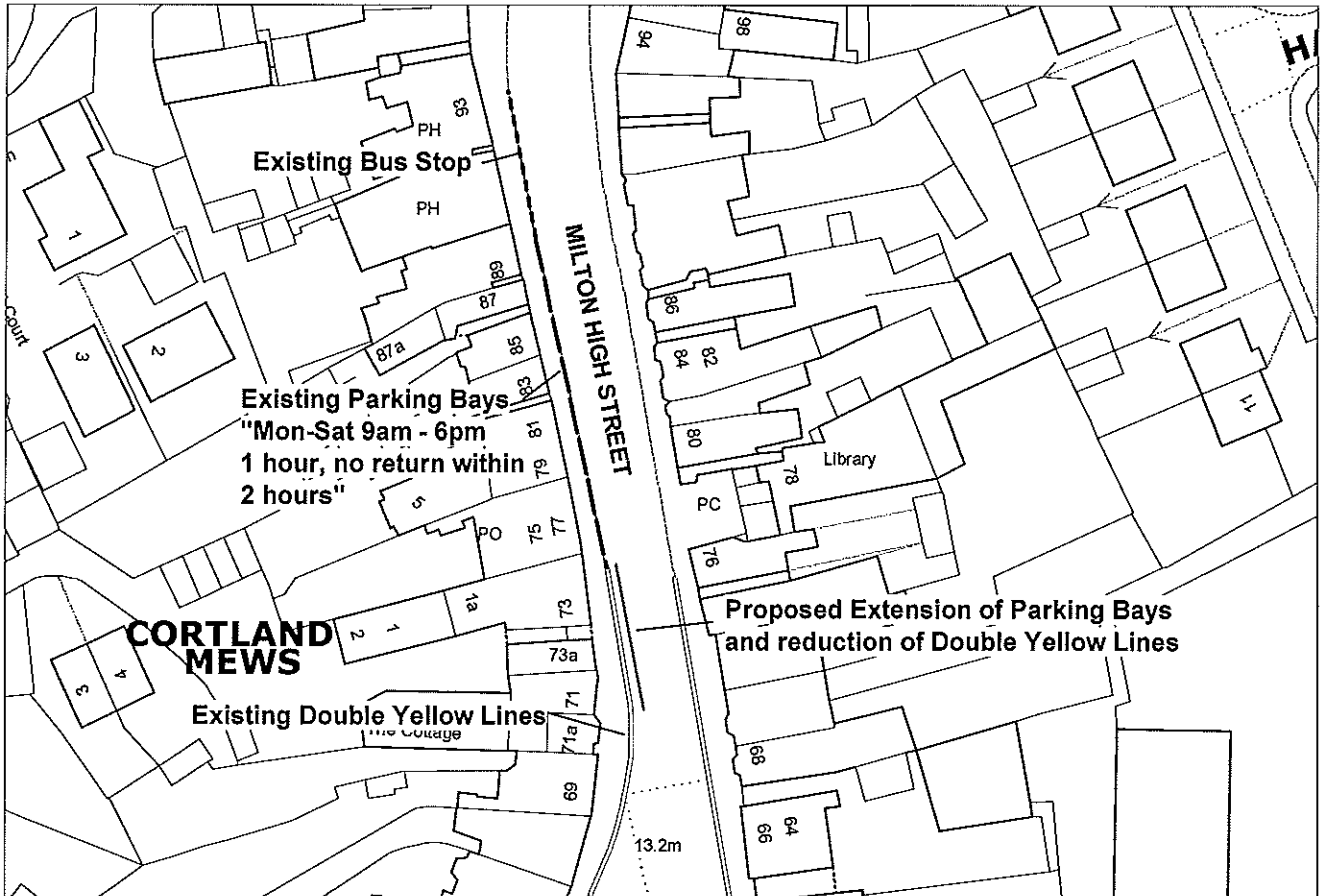

ADDRESS BLOCK



## Proposed Single Yellow Line The Broadway, Minster

A request has been received from Minster Parish Council for waiting restrictions to be introduced in the layby outside of the parade of shops in The Broadway, Minster. There have been reports that vehicles are parking in this area for long periods of time, reducing the amount of available space for visitors to the shops.

It is therefore proposed to install a single yellow line in the layby, with a one hour waiting restriction between 8:30am and 5:30pm Monday to Saturday.

The installation of these parking amendments will be dependant on available funding.

If you support or object to the proposal please complete the reply slip below and return to the Borough Council in the pre-paid envelope provided, before Friday 5<sup>th</sup> November 2010. A space has also been provided to allow you to add any further comments you may have.

---

### Proposed Installation of Single Yellow Line – The Broadway, Minster

Please tick one of the following boxes

I Support the proposal to install single yellow line
  I Object to the proposal

Name & Address	Comments

The information supplied will only be used in conjunction with this proposal, and used for geographical analysis purposes only



Plan of proposed restrictions

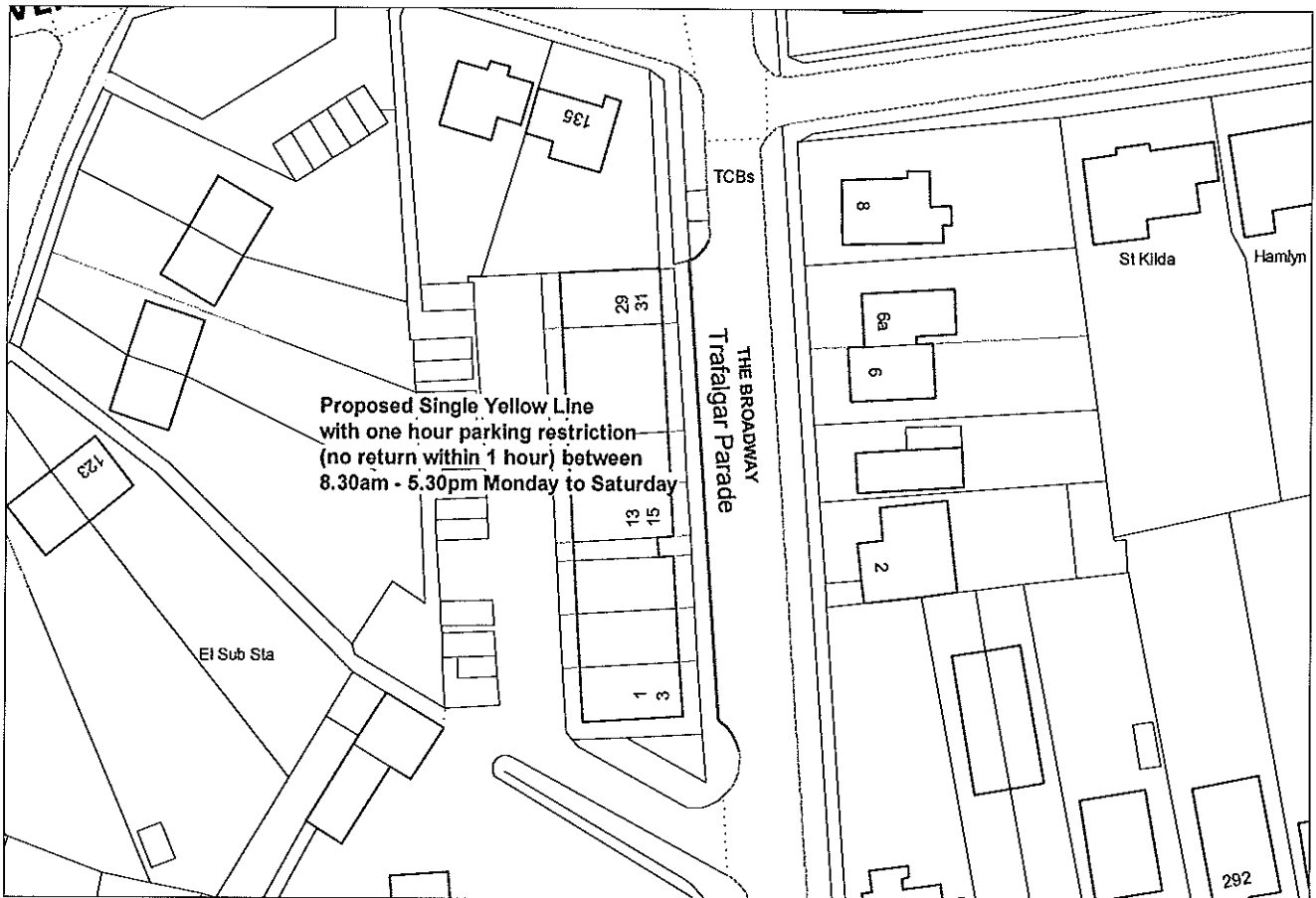

ADDRESS BLOCK



## Proposed Single Yellow Lines Ethelbert Road, Faversham

A petition containing 29 signatures from residents in Ethelbert Road has been received by the Borough Council. The petition requested further consultation with residents on the introduction of possible waiting restrictions in the road, to tackle problems with vehicles parked for long periods of time.

It is therefore proposed to install single yellow lines on both sides of the full length of Ethelbert Road, with a one hour parking restriction between 10am and 11am Monday to Friday. It is anticipated that this will prevent vehicles parking all day, but minimise the impact on residents and other road users.

The installation of these parking amendments will be dependant on available funding.

If you support or object to the proposal please complete the reply slip below and return to the Borough Council in the pre-paid envelope provided, before Friday 5<sup>th</sup> November 2010. A space has also been provided to allow you to add any further comments you may have.

---

### Proposed Installation of Yellow Lines – Ethelbert Road, Faversham

Please tick one of the following boxes

I Support the proposal to install single yellow lines

I Object to the proposal

Name & Address	Comments

The information supplied will only be used in conjunction with this proposal, and used for geographical analysis purposes only



Plan of proposed restrictions

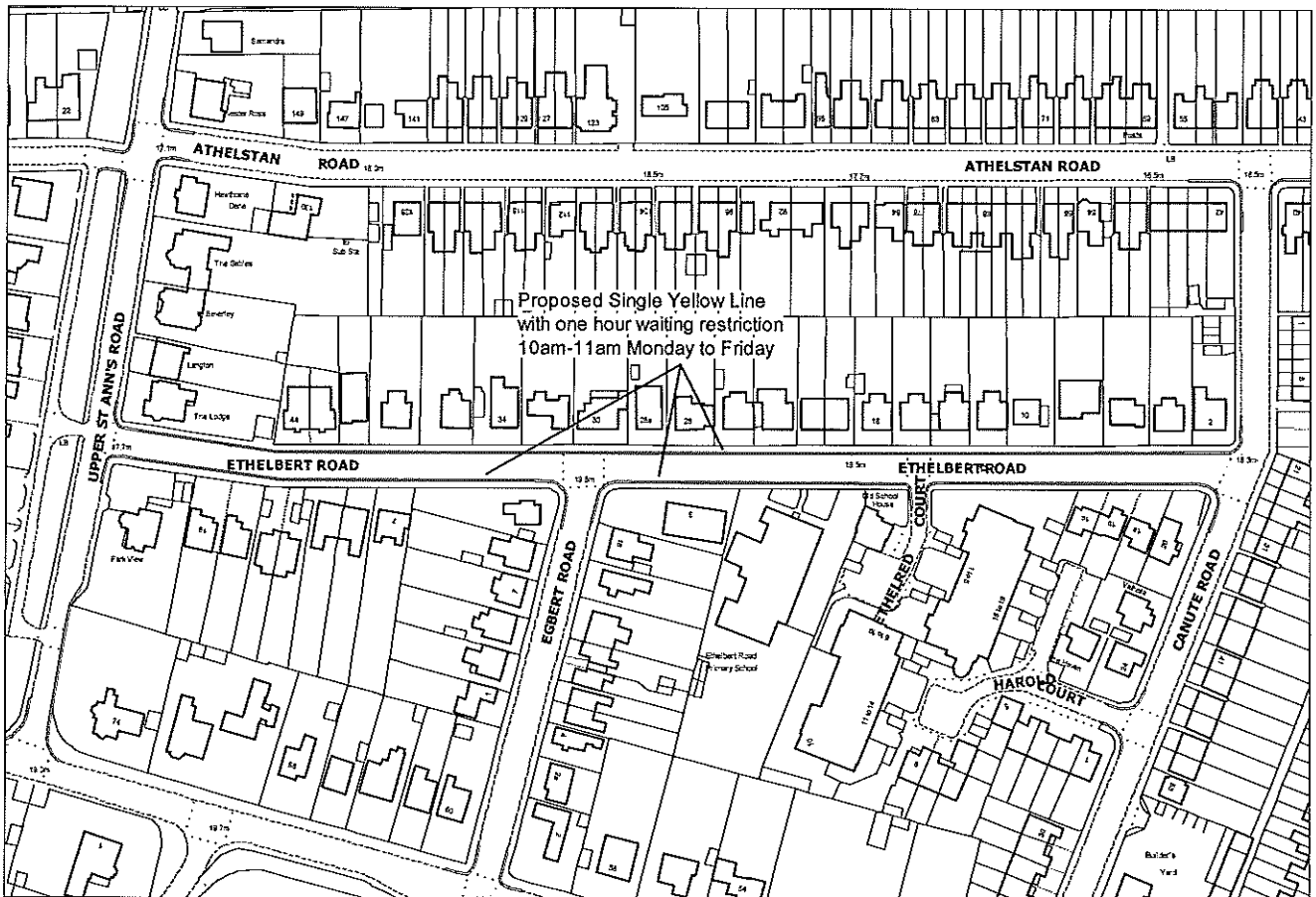

ADDRESS BLOCK

## Proposed Double Yellow Lines Keycol Hill, Newington/Bobbing

A request has been received from Bobbing Parish Council for waiting restrictions to be installed along the A2 at Keycol Hill in Newington and Bobbing. It has been reported that vehicles parked part on the footway are obstructing the safe passage of pedestrians along this section of road, forcing those with pushchairs or wheelchairs into the road. In addition to this, some residents have reported that these parked vehicles are obstructing sightlines when exiting their driveways.

It is therefore proposed to install double yellow lines on both sides of the road, as shown on the plan overleaf. The Police have also endorsed the request for restrictions at this location due to the issues of obstruction. I would confirm that Newington Parish Council will be included in this consultation as the proposals also fall within their Parish.

The installation of these parking amendments will be dependant on available funding.

If you support or object to the proposal please complete the reply slip below and return to the Borough Council in the pre-paid envelope provided, before **Friday 12<sup>th</sup> November 2010**. A space has also been provided to allow you to add any further comments you may have.

**Please note:** These are revised proposals to our previous letter – apologies for any inconvenience or confusion caused.

---

### Proposed Installation of Double Yellow Lines – Keycol Hill, Newington/Bobbing

Please tick one of the following boxes

I Support the proposal to install double yellow lines       I Object to the proposal

Name & Address	Comments

The information supplied will only be used in conjunction with this proposal, and used for geographical analysis purposes only





Plan of proposed restrictions

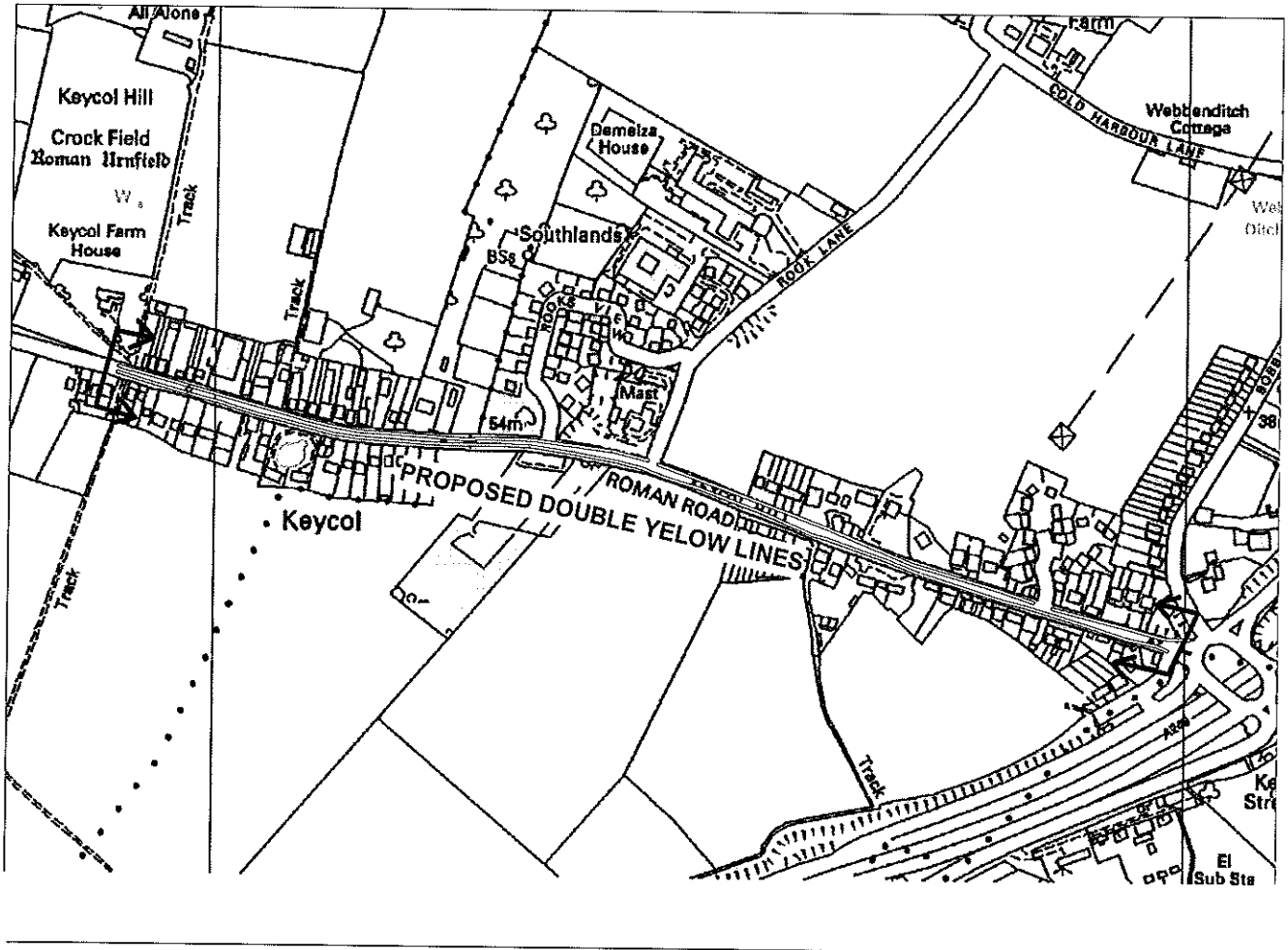

ADDRESS BLOCK